

150mm thick Perforated
RCC Slab (M250) with
38mm dia perforations at
230mm Distance on Both
sides.

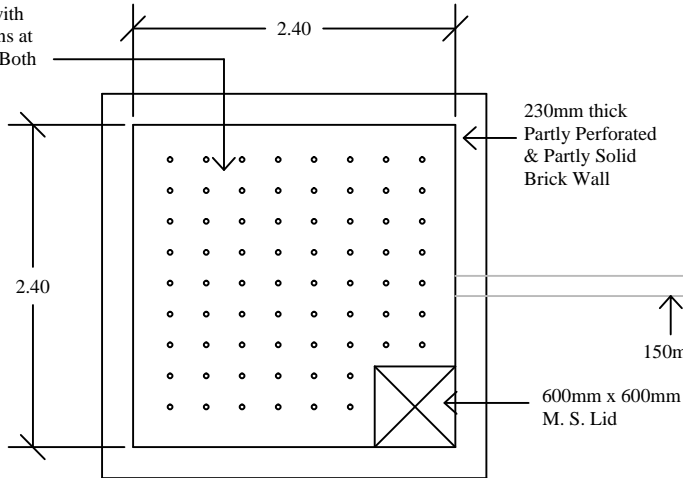

**PERCOLATION
WELL PLAN**

230mm thick
Solid Brick Wall

150mm Dia PVC Pipe

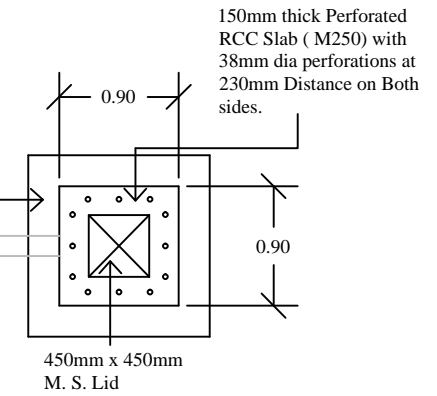

CATCH PIT PLAN

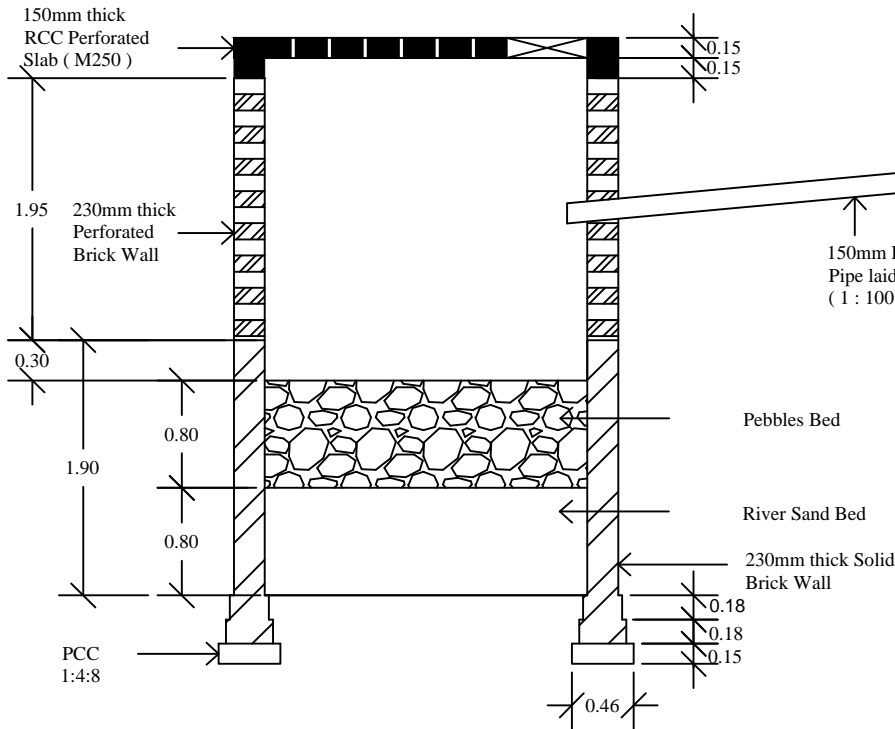

**CROSS SECTION
PERCOLATION WELL**

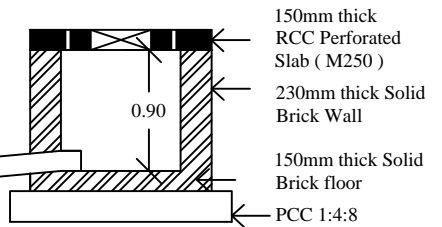

**CROSS SECTION
CATCH PIT**

150mm Dia PVC
Pipe laid in slop
(1 : 100)

Pebbles Bed

River Sand Bed

230mm thick Solid
Brick Wall

PCC
1:4:8

0'0" 2'0" 4'0" 6'0"

NOTE : 1) DRAWING IS NOT TO BE SCALED. ONLY WRITTEN
MEASUREMENTS SHALL BE FOLLOWED.
2) DISTANCE BETWEEN PERCOLATION WELL & CATCH PIT
SHALL BE KEPT AS PER THE SITE CONDITION.

DRAWING NO. WD - 04	DATE 14-07-2022	DRAWN BY SAJEDA	CHECKED BY V. V. T.
PROPOSED PERCOLATION WELL & CATCH PIT (DESIGN AS RECOMMENDED IN GDCR 2017)			
REPAIRING WORK OF DHANPAL APARTMENTS OWNED BY CANARA BANK AND LOCATED AT SURAT.			
MESSRS VIRAT V. THAKORE			
ARCHITECTS, URBAN DESIGNERS & VALUERS, 98/1, SAMASTA SOCIETY, AHMEDABAD - 380 007.			